



## UNITREK SLIMLINE - STR9015/DC

Single circuit, dimmable 15/20/28 watt architectural track spot, with integral driver, selectable power and CCT

### Application

Ideal for decorative retail or interior residential spaces

### Design Specifications

- Durable aluminium body profile in a choice of white or black
- High performance LED optics, CRI >90, beam distribution 40° and selectable CCT 3000K / 4000K / 5700K
- Integral trailing edge dimmable driver, with flickerCONTROLLED technology
- Selectable power 10/15, 15/20, 20/28 watt
- Horizontal optical rotation of 355° and vertical tilt of 90°
- Single circuit design.



### Performance

- Dimmable - **YES**
- Dimmer Type - **trailing edge**



## Technical Specification

Product	Model No.	Input Voltage (V/AC)	Multiple Wattage	Lumens (lm)	CCT (K)	Body Colour
	STR9015/15DC/BK	240	10/15	1350/1420/1420	3000/4000/5700	BLACK
	STR9015/15DC/WH	240	10/15	1350/1420/1420	3000/4000/5700	WHITE
	STR9015/20DC/BK	240	15/20	1800/1900/1900	3000/4000/5700	BLACK
	STR9015/20DC/WH	240	15/20	1800/1900/1900	3000/4000/5700	WHITE
	STR9015/30DC/BK	240	20/28	2520/2660/2660	3000/4000/5700	BLACK
	STR9015/30DC/WH	240	20/28	2520/2660/2660	3000/4000/5700	WHITE

CRI	Beam Angle (°)	Dimmable	Dim (mm)	Diameter (mm)
90	40	YES	128(H)	42
90	40	YES	128(H)	42
90	40	YES	128(H)	50
90	40	YES	128(H)	50
90	40	YES	128(H)	60
90	40	YES	128(H)	60

Note: Lumens displayed are at the maximum power selection

Due to continued product and technology enhancements, data sourced from sal.net.au shall not form part of any contract and or technical performance guarantee unless expressly confirmed in writing by SAL at the time of order. Products are sold in accordance with [SAL Terms and Conditions of sale](#) and all images shown are for illustration purposes only and may vary from the actual colour or finish. Unless specifically stated, all IP ratings nominated for Interior products are from "below the ceiling".

## Dimensions

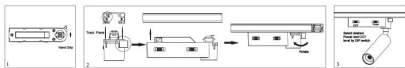

Figure 1: Please turn off the power before installation. Rotate the power switch and handle to the position as shown in Figure 1.  
Figure 2: Make sure the ring is in the correct place on the track, please and then press the track adapter over the track space.  
Push the handle back to the position of the arrow.  
Figure 3: Select the power and color temperature of the lamp, turn the ring to the desired direction and connect the power supply.

### STR9015/15DC - STR9015/20DC - STR9015/30DC

