



## PIXIE SMART SWITCH SWL350BT G2

SMART HOME push button switch, Generation 2

### Application

Smart digital lighting control with Bluetooth Mesh Technology for residential and commercial spaces

### Design Specifications

- Digital push button control with three (3) complimentary key caps provided to suit most switch plates
- Smaller design profile and easier to install with large wiring terminals
- Operating the device with the PIXIE or PIXIE PLUS app allows the user to set a scene, group devices, set a schedule, set a timer and more!
- With the inclusion of the SAL PIXIE Gateway and the internet, you can control your PIXIE devices from anywhere in the world
- Overheating, overload and full short circuit protection, maximum load 350 watt, minimum load 13 watt\*. For load type compatibility, please refer to installation instructions.
- SMART LED indicator, Fits most branded switch plates. 1, 2 or 3 gang, complies to AS/NZS 60669.2.1, typical wireless range 15 metres



### Technical Specification

Model No.	Power (W)	Input Voltage (V/AC)	Dim (mm)
SWL350BT	350	240	40(L) x 24(W) x 38(H)

\*Subject to product capability, this size load may require the inclusion of the LOAD capacitor included in the product carton

Due to continued product and technology enhancements, data sourced from sal.net.au shall not form part of any contract and or technical performance guarantee unless expressly confirmed in writing by SAL at the time of order. Products are sold in accordance with [SAL Terms and Conditions of sale](#) and all images shown are for illustration purposes only and may vary from the actual colour or finish. Unless specifically stated, all IP ratings nominated for Interior products are from "below the ceiling".

### Dimensions

SWL350BT

**SWL350BT G2 - Standard wiring diagram**

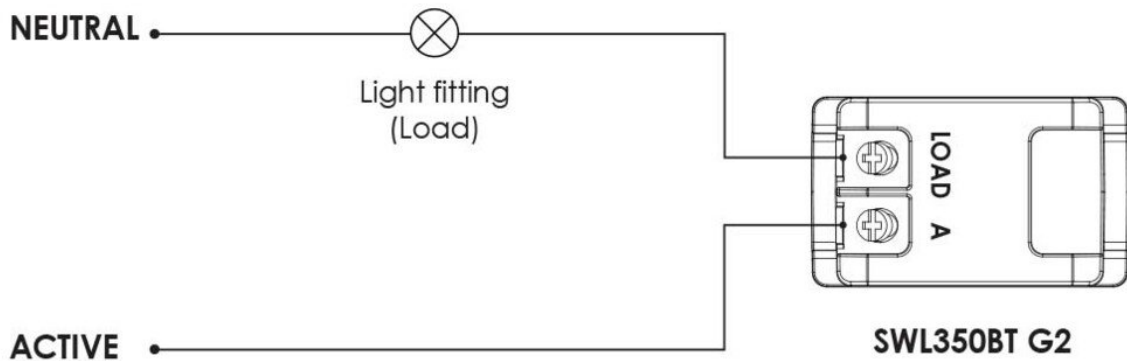

**Complimentary load capacitor provided:**

- The SWL350BT G2 is a 2 wire product, the capacitor provided in the carton operates as a load correction device to assist achieving minimum load levels and improve compatibility performances.

**SWL350BT G2 - Optional wiring diagram**

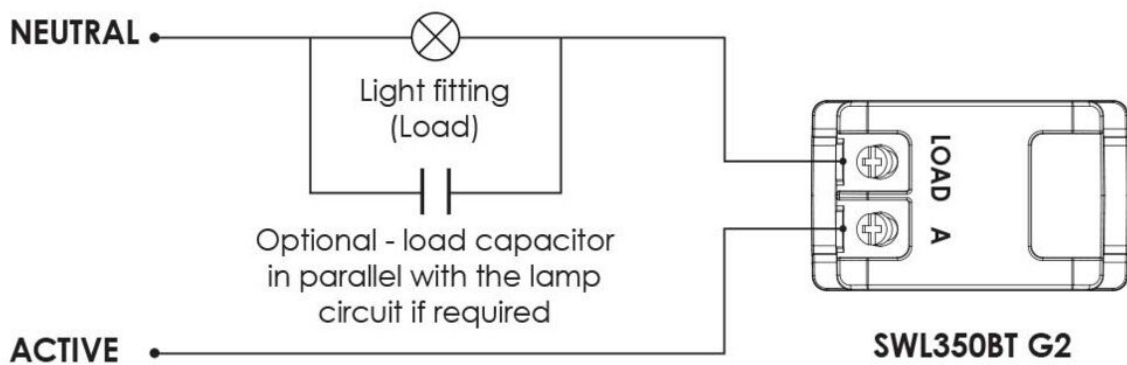

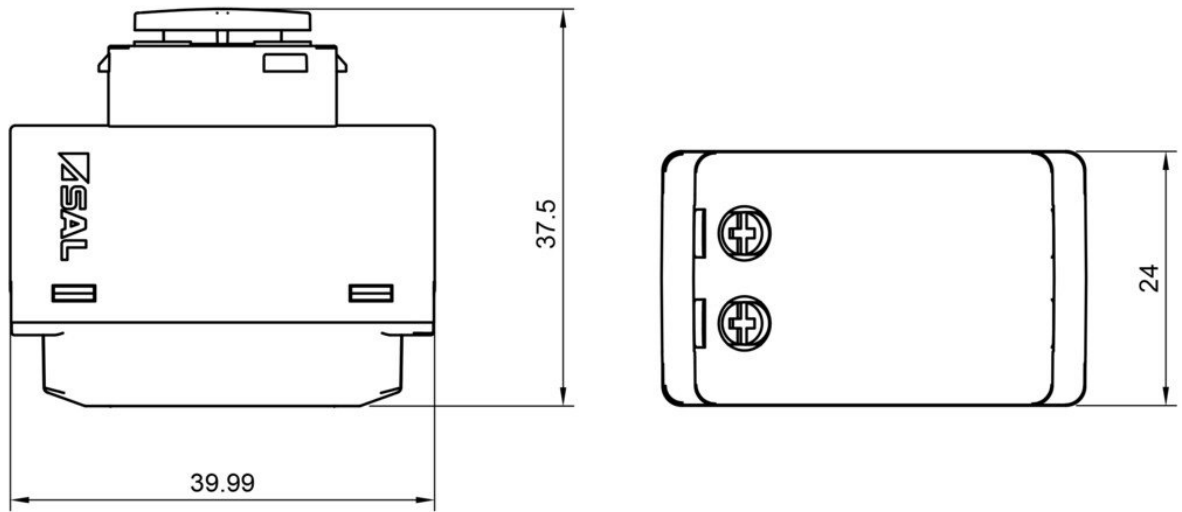

## Product Images

**PIXIE PLUS app control features include:** set scenes, no need for cumbersome portable wall mount devices, **sceneable timer** allows you to dim or switch devices on or off with brightness control and memory, **group function** allows you to group dimmers or switches, **scene function** allows you to set a scene and create an exciting ambience, **sync** PIXIE RGB LED strip to your favourite music.

- Device**  
Manage devices, individual control
- Group**  
Simultaneous control of up to 32 x PIXIE devices
- Schedule**  
Schedule your lights
- Scene**  
Create preset lighting scenes
- Timer**  
Countdown, turn-off timer
- Sync**  
PIXIE RGB fullcolor strip to music

The PIXIE PLUS app is smart enough to control multiple HOME locations, work or play!

PIXIE PLUS is compatible with popular voice control devices.

works with the Google Assistant

And Amazon Alexa