

# ICON 52" CEILING FAN



Brushed Aluminium no light

## Installation Locations:

Indoor and outdoor (provided the fan is fully undercover)

## Standard Canopy Cover:

Suitable for flat and pitched ceilings up to 28°

## Recommended Height:

There should be at least 2.1m between the lowest point of the fan blades and the floor.

## Wall Controller Speed Capacitor Values:

3µF & 2µF

## Top of canopy cover to lowest point of the fan without light fittings attached:

Approximately 280mm

## Rotational Diameter:

1320mm (52") blade sweep

## Ceiling to top side of the blade:

Approximately 222mm

## Motor:

16 Pole, 172mm x 14mm motor

Made with the highest grade copper windings and silicone steel stator. Bearings are sealed to ensure quiet operation and long life.

## Weight Including Packaging:

Complete fan: 10.5kg

## Motor Housing:

Materials: Die Cast Aluminium

## Packaging Dimensions (cm):

Complete Fan: 63L x 35W x 38H

## Available Colours :

White & Brushed Aluminium

## Accessories:

Remote Control

Extension Down Rod 26mm diameter

45° Ceiling Kit (for pitched ceilings)

T-Hook for ceiling roses

Universal Mounting Brace

## Blades:

Sizes: 1320mm (52")

Materials: NZ plywood, Painted finish

Blade Pitch: 12°

## Warranty

2 years "in home" covering major defects

3 Years additional covering motor only (not labour)

Remotes -1 year "in home" covering major defects. (receiver and handpiece)

Lights -1 year "in home" covering major defects

## Available Blade Colours:

White & Brushed Aluminium

## Airflow and Efficiency:

Airflow measured in Australia using the "Energy Star Solid-State Test Method", the only test method recognised For USA Energy Star compliance.

## Extra Information:

Introduced into the HPI range in 2008

3 Speed wall controller

Light adaptable

Reversible

	HIGH	MED	LOW
<b>RPMS</b>	<b>187</b>	<b>120</b>	<b>92</b>
<b>WATTS</b>	<b>71.4</b>	<b>31.1</b>	<b>16.9</b>
<b>AIRFLOW<sup>^</sup>: AUS-ES / USA-ES</b>	<b>8472 / 11437</b>	<b>5324 / 7187</b>	<b>3874 / 5230</b>
<b>EFFICIENCY<sup>^</sup>: AUS-ES / USA-ES</b>	<b>118.66 / 160.18</b>	<b>171.19 / 231.11</b>	<b>229.23 / 309.46</b>

<sup>^</sup> Airflow measured in Cubic metres/ Hour (CM/HR), Efficiency measured in CM/HR per watt (CMH/W)

# For full warranty details please see Hunter Pacific International's website [www.hunterpacific.com.au](http://www.hunterpacific.com.au)

# ICON 52" CEILING FAN LIGHTING



## 78mm Halogen Light (MAX 100W)

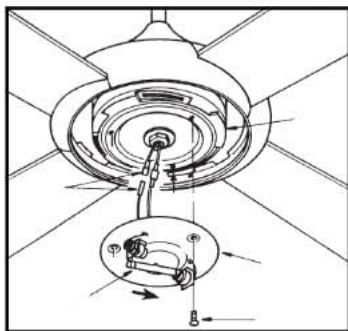

- Cost effective
- Colour—warm white
- Dimmable
- Compact in size



78mm linear Halogen Light globe



## E14 Light ( MAX 2x40W)

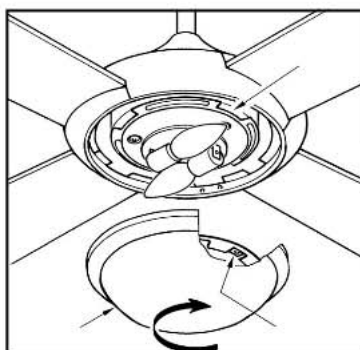

- Accepts a variety of lamps, e.g. incandescent, fluorescent.
- Cost effective
- Compatible with some CFL lamps



**Colours Available:**  
available in motor colours  
~ White and Brushed  
Aluminium

**Packaging Dimensions**  
25L x 25W x 10H  
Weight: 1kgs  
240mm diameter  
80mm depth (glass & rim)

## GX53M 14W Compact Fluorescent Light

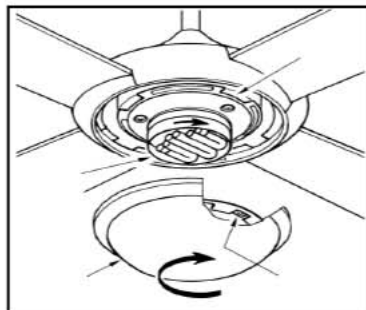

A Base  
B Lamp Assembly  
C Tube

- Low wattage
- High light output
- Liquid mercury free
- Colour—Warm white/Cool white colour temperatures available
- Low heat
- 12000 hour life span
- 2700k or 3000k

## Flat 6, 26W Fluorescent Lamp

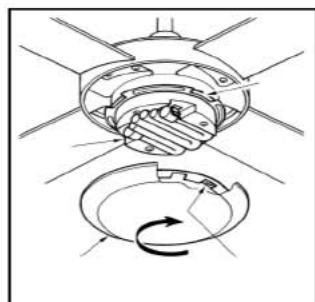

- High Efficiency (EEI=A2)
- High light output
- Liquid mercury free
- Low heat
- Fewer shadows visible
- Dimmable on certain fan models; eCO<sup>2</sup> & Ice Range (with Model 089 FLDR)
- 4100k

^ All light kits must be installed by a licensed electrician. For further information about correct installation procedures, please see [www.hunterpacific.com.au](http://www.hunterpacific.com.au)

# For full warranty details please see Hunter Pacific International's website [www.hunterpacific.com.au](http://www.hunterpacific.com.au)