

AEROFORCE CEILING FAN



Shadow Chrome with Koa finished blades

Installation Locations:

Indoor and outdoor (provided the fan is fully undercover)
(Shadow Chrome not recommended outdoor)

Standard Canopy Cover:

Suitable for flat and pitched ceilings up to 28°

Recommended Height:

There should be at least 2.1m between the lowest point of the fan blades and the floor.

Wall Controller Speed Capacitor Values:

3.5µF & 2µF

Top of canopy cover to lowest point of the fan:

Approximately 337mm

Rotational Diameter:

1320mm (52") blade sweep

Ceiling to top side of the blade:

Approximately 265mm

Motor:

16 Pole, 172mm x 20mm AC motor
Made with high grade copper windings and silicone steel stator. Bearings are sealed to ensure quiet operation and long life.

Weight Including Packaging:

Complete fan: 7.52kg

Packaging Dimensions (cm):

Complete Fan: 74.5L x 27W x 24.5H

Motor Housing:

Materials: Die-Cast Aluminium

Accessories (Supplied separately):

Remote Control
Extension Down Rod 26mm diameter
38° Ceiling Kit (for pitched ceilings)
T-Hook for ceiling roses
Accessory light

Available Motor Housing Colours :

Shadow Chrome

Blades:

Sizes: 1320mm (52")
Materials: Plastic
Blade Pitch: 48° average

Warranty

1 year standard warranty "in home" on electronic parts
2 years standard warranty "in home" on mechanical parts (including motors)
3 years extended warranty on motor only (excluding labour)

Available Blade Colours:

White, Silver, Koa

Extra Information:

Introduced into the HPI range in 2015
3 Speed wall controller
Reversible

Airflow and Efficiency:

Airflow measured in Australia using the "Energy Star Solid-State Test Method", the only test method recognised for USA Energy Star compliance.

	HIGH	MED	LOW
RPMS	193	145	85
WATTS	76.7	44.3	15.6
AIRFLOW: CFM* / CMH*	9276 / 15830	6568 / 11208	3745 / 6391
EFFICIENCY[^]: (CFM / Watt) / (CMH / Watt)	121 / 206	148 / 253	193 / 329

* CFM = Cubic Feet per Minute / CMH = Cubic Meters per Hour.

[^] Efficiency measured as airflow rate per Watt.

For full warranty details please see Hunter Pacific International's website www.hunterpacific.com.au

ACCESSORY CEILING FAN LIGHTING - SUITABLE FOR INSTALLATION WITH AEROFORCE



LED 17W 3000K — (non-dimmable)

Packaging Dimensions:

Inner box: 14L x 14W x 4.7H cm

Inner box weight: 0.28kgs

Outer carton (6pcs) : 30L x 24.5W x 16H cm

Outer carton weight (10pcs): 3.11kgs



Simple Click-on design

! Light must be installed by a licensed electrician

Remove base plate

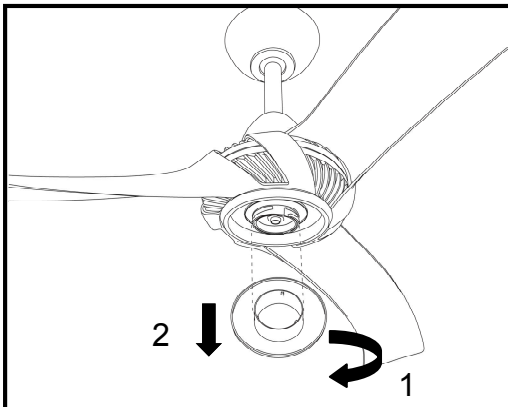

Add light

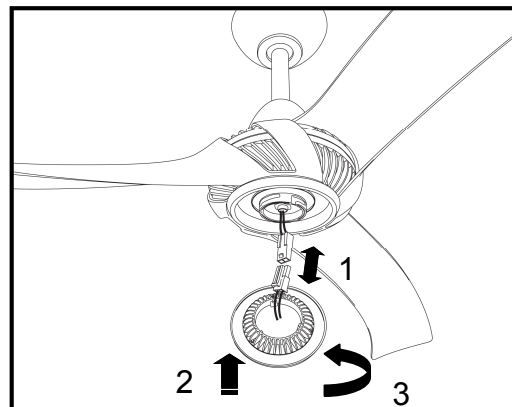

^ All light kits must be installed by a licensed electrician. For further information about correct installation procedures, please see www.hunterpacific.com.au

For full warranty details please see Hunter Pacific International's website www.hunterpacific.com.au