

TRIANGOLO ALLUMINIO 4231 2x18W 2G11IP65   

230 V

50 Hz

goccia
ILLUM NAZIONE

Class I

Glow wire 960°

Impact test: 6 joules

Electromagnetic compatibility CEE 89/336 - EN 55015 III Ed. - EN 61000 - 3 - 2

Definition and application

Waterproof fixture completely in die-cast aluminium with triangular section 242x242x281mm. The tempered glass diffuser with refractor FRESNEL lens is oriented 45° downwards. Cable entry from the back or the side. Through wiring allowed.

To be installed on wall, on ceiling, on the corners, oriented towards the floor or towards the ceiling or on the post.

Lighting sources:

2G11 lampholder 2x18 W

Illuminance level: **2400** LumenLife: **8000** h

Tonality:

2700° K warm**3500°** K white**4200°** K very white lightDescription

Housing and cover in die-cast aluminium.

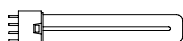

PL18 W - 2G11

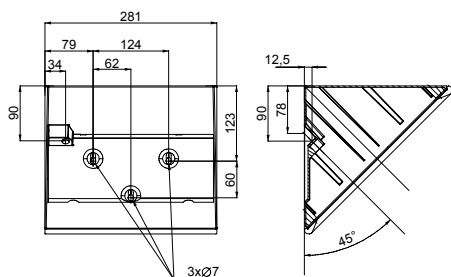
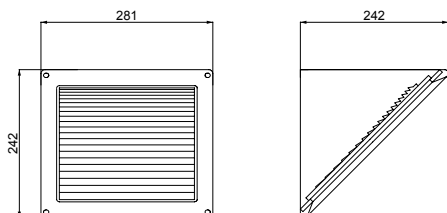

Fresnel lens diffuser made of tempered opal glass.

Gasket: Silicone antiaging rubber

Terminal block: Stucchi 676 A

Reflector: polished 99,5 aluminium

Ballast: Vossloh LN 36.172

Lampholder: Stucchi 441/V

Starter: LC RELCO SC480

FinishPickling, phosphochrome, polyester powder coating, UV resistant
+ (only silver) transparent coating UV resistantPhotometryEfficiency $\mu = 60\%$

The diagram of illuminance is central and oriented downwards. If you rotate the diffuser for 180°, you invert the lighting direction upwards.

Installation:

Three fixing holes in the base.

Cable entry from the rear or from the side. PG11 and IP 68 cable gland.

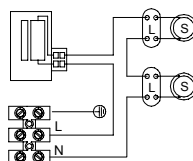
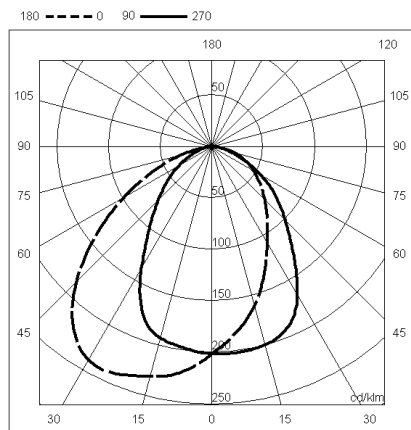

Wiring diagram