

BL-5082

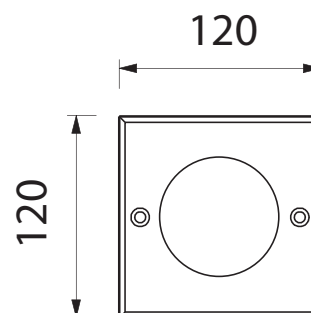

BL-5082.090

Lamp: QT9
Power: 20W
Base: G4

BL-5082.120

Lamp: QT12
Power: 50W
Base: GY 6.35

BL-5082.130

Lamp: QT14
Power: 25W
Base: G24 d-3

BL-5082.140

Lamp: QT14
Power: 40W
Base: G9

BL-5082.600

Lamp: T2
Power: 6W
Base: Gx53

BL-5082.680

Lamp: 60 x White LED
Power: 4W
LED: 260lm 4000K

BL-5082.160

Lamp: 12 x White LED
Power: 6W
LED: 25lm 6000K

BL-5082.880

Lamp: 1 x White LED
Power: 4.1W
LED: 230lm 6300K

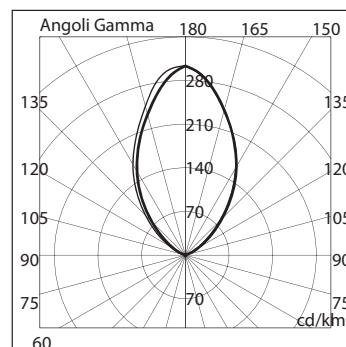

5082 14



- Outdoor recessed ground luminaire
- Painted die-cast aluminium body
- Stainless steel AISI 316 or die-cast aluminium ring
- Satin tempered glass diffuser
- Aluminium reflector
- Silicon gasket
- Stainless steel screws
- Technopolymer holder
- Painting using high resistance to UV and corrosion polyester powders

Domus Lighting

29-31 Richland Street Kingsgrove NSW 2208

Phone: (02) 9554 9600 | Fax: (02) 9554 9433 | Email: sales@domuslighting.com