

BL-5056

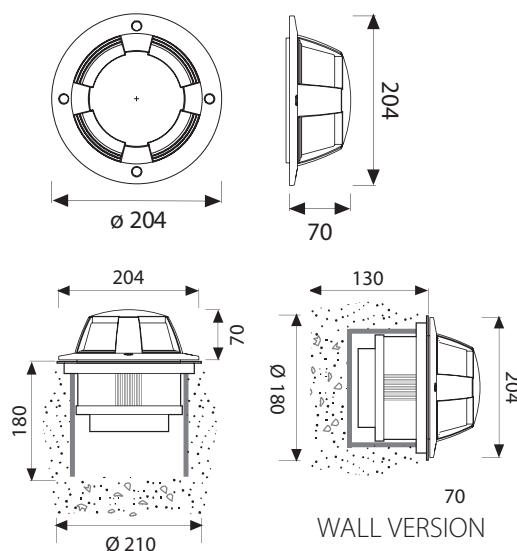

GROUND VERSION

BL-5056.00X
Lamp: A60
Power: 75W
Base: E27

BL-5056.84X
Lamp: TC-T
Power: 18W
Base: Gx24 d-1





BL-5056.88X

Lamp: 1 LED
Power: 4.1W
LED: 230lm 6300K

- Outdoor recessed ground or wall luminaire constructed
- Painted die-cast aluminium body
- Transparent glass diffuser
- Silicon gaskets
- Stainless steel screws
- Polypropylene holder for ground fixing and technopolymer holder for wall fixing
- Painting using high resistance to UV and corrosion polyester powders

Available Colours:

X=3  Black X=9  Anthracite
X=4  Silver

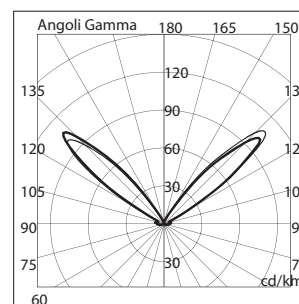

5056 00



Domus Lighting

29-31 Richland Street Kingsgrove NSW 2208

Phone: (02) 9554 9600 | Fax: (02) 9554 9433 | Email: sales@domuslighting.com