



LIGHTING THAT OUTPERFORMS
SINCE 1998

GAMMA LINEAR LIGHT

V2 series



Introduction

▼ Features

1. Meet the needs of various engineering designs
2. Ugamma pendant luminaires with common linear light distribution produce superb uniformity when arranged centrally above the table
3. Ugamma offers nice glare-control, protects people's eye perfectly; but the most important and challenge is in the meantime, delivers a wide beam distribution angle for Space lighting
4. According to customer needs, customization is optional:
Milky diffuser; Micro-prismatic diffuser, reflector, wall wash LENS.....
5. Seamless linkable: different lengths can be random combined

Optoelectronic advantages

1. Standard: 110lm/W
2. Beam angle 110
3. SDCM < 6
4. 3 CCT switchable
5. 3 Wattage switchable
6. Tool free connection
7. Plug & Play uplight module
8. DALI/0-10V dimmable is optional.



Application notes

- Do not touch when in use
- Switch off before installation
- Professional electrician for installation only
- Keep away from hot steam and corrosive gas



Certificates



RoHS
Compliant

Linkable details

XTL Connectors

- GAMMA linear light, offer different linkable shape, "T" , "X" and "L", with LED light.
- Modern splicing, make the multi shapes and beautiful.

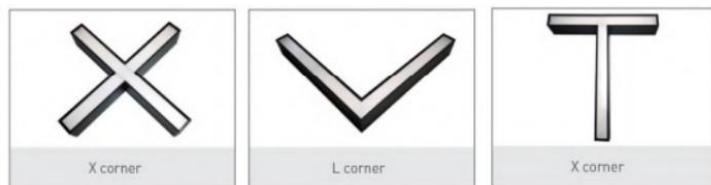

Through cable Connection Screw free housing Connection

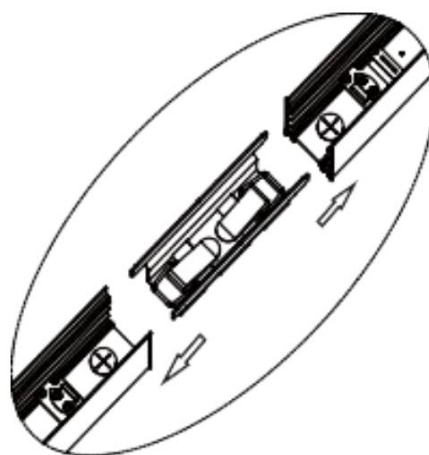
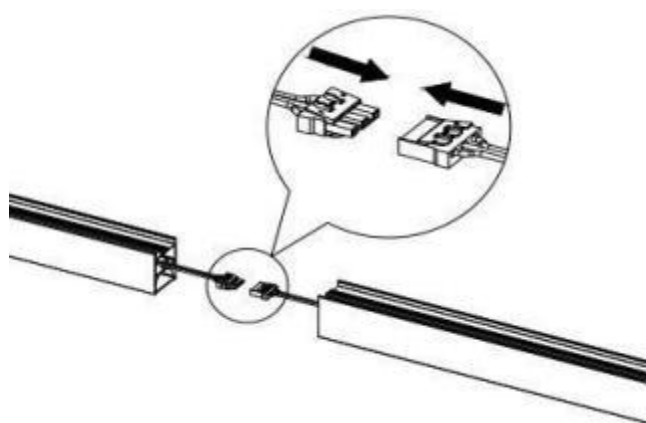

Continuous Opal/ Micro-Prismatic diffuser (Optional)

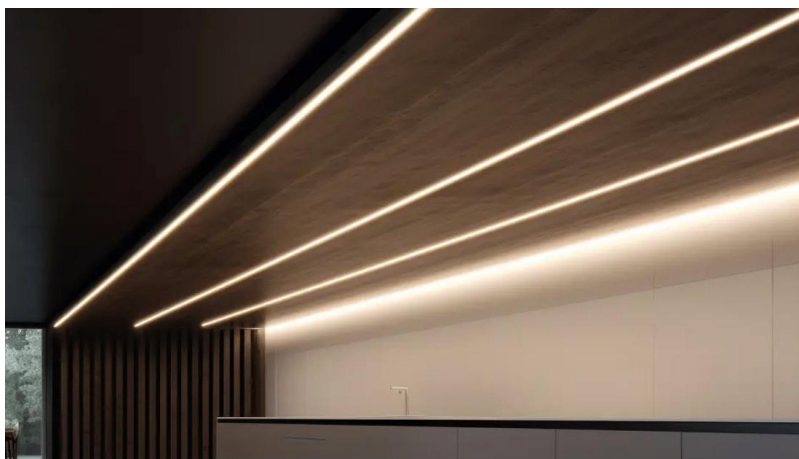

Plug & Play Uplight module

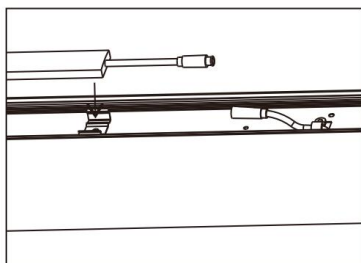

Product Information

Dimensions

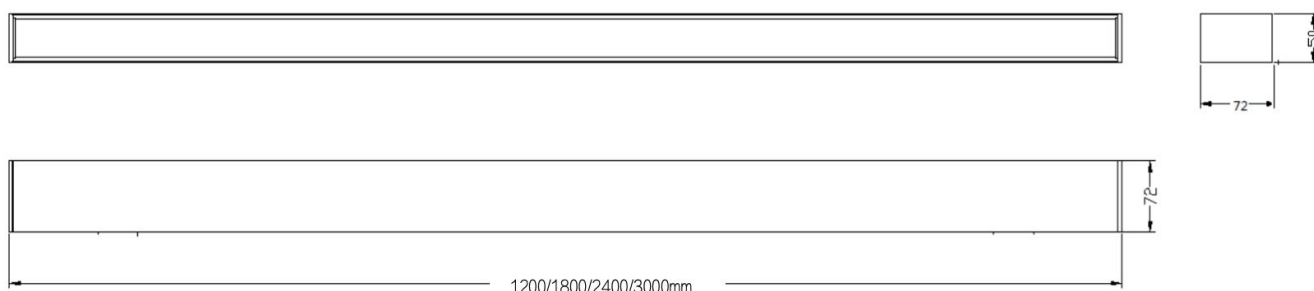

Technical Specifications

Model	Power(W)	Lumen(±10%) (lm)	Beam angle	Size (mm)	Colour Temperature(K)	CRI
UGAMMA-V2-WH/BLK-1.2M	20/30/40	2200/3300/4400	110°	1200*50*72	3000K/4000K/5500K 3CCT	≥90
UGAMMA-V2-WH/BLK-1.8M	40/50/60	4400/5500/6600	110°	1800*50*72	3000K/4000K/5500K 3CCT	≥90
UGAMMA-V2-WH/BLK-2.4M	40/60/80	4400/6600/8800	110°	2400*50*72	3000K/4000K/5500K 3CCT	≥90
UGAMMA-V2-WH/BLK-3M	40/60/80	4400/6600/8800	110°	3000*50*72	3000K/4000K/5500K 3CCT	≥90

Fixture Compatibility

Rated Wattage	Electrical Classification	Ingress Protection	Operating Temp	IK	Storage Temp.
40/60/80W	I	IP20	-20°C~45°C	08	-40°C~60°



Installation Manual

(Surface mount kit is packed in one end of inner box)

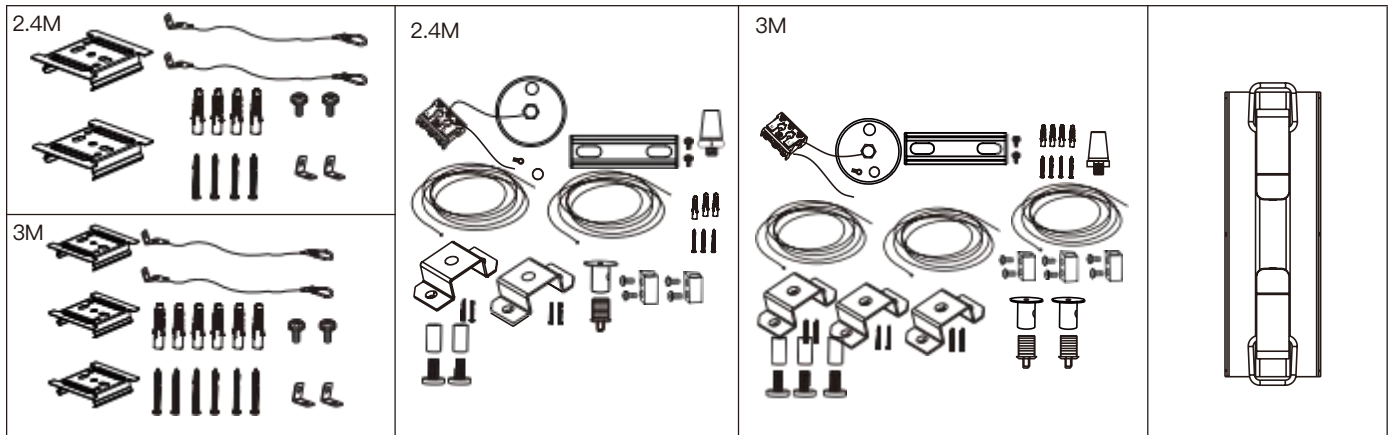

Surface mount bracket and security cables.

Suspension KIT

STRAIGHT JOINING CONNECTOR (OPTIONAL)
Product NO.:
UGAMMA-V2-
STRAIGHTJOINER

(Voids Warranty if surface mount bracket is install as suspension kit)

Surface mount installation

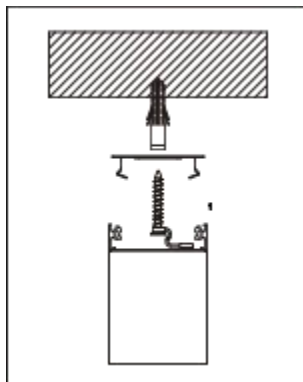

1 .Drill a hole and insert the expansion rubber plug in the ceiling. Thread the safety

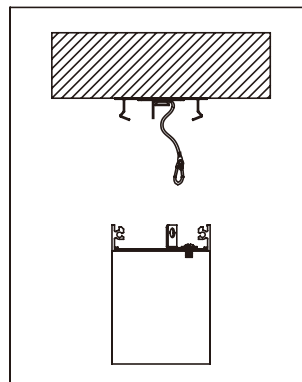

2. Fix the "L" bracket to the back plate with a screw. Fasten the buckle .

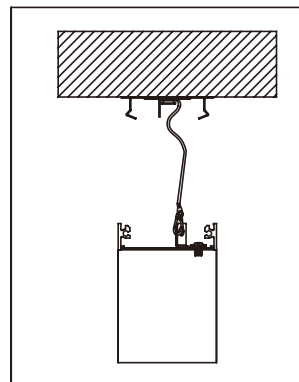

3. Fasten the buckle to the safety cable.

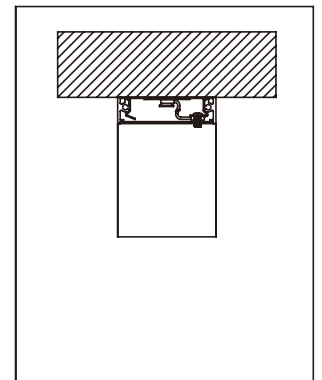

4. Clip the lamp to the surface mount brackets.

Uplight Module Lighting Installation (OPTIONAL)

"SOLD SEPARATELY", Product No.:UGAMMA-V2-UPLIGHT

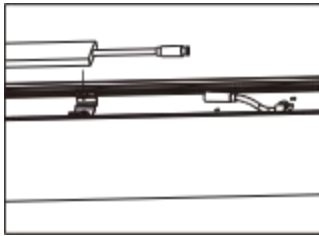

Install the up light module onto the clips of the light fixture.

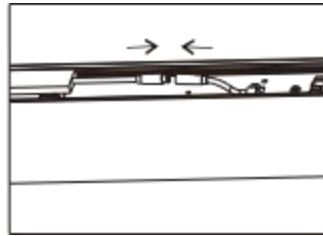

Connect the male connector of the module to the female connector on the fixture.

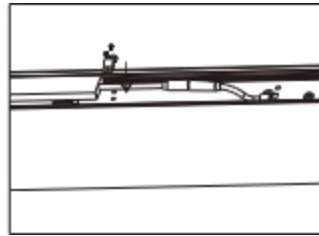

Secure the female connector wire of the up-light module with a strain relief clip

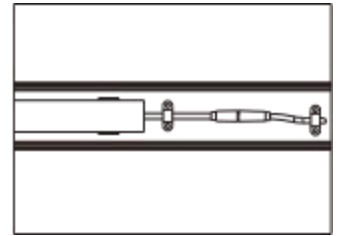

Finished

Suspension Installation

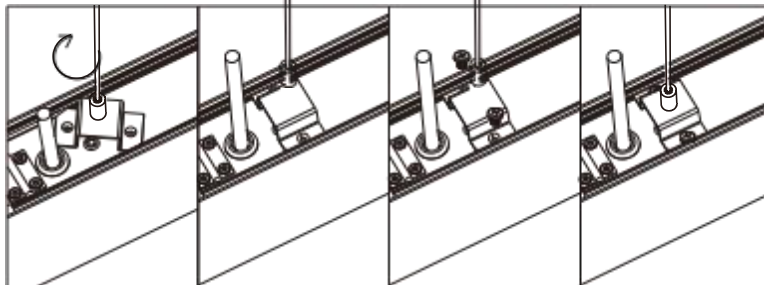
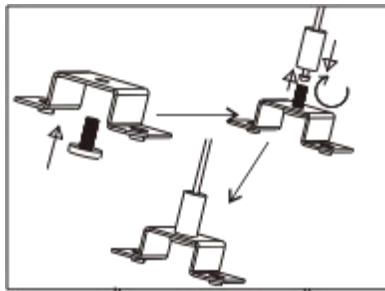

1. Fix one end of the suspension cable to the bracket and , then fix the bracket to the fixture.

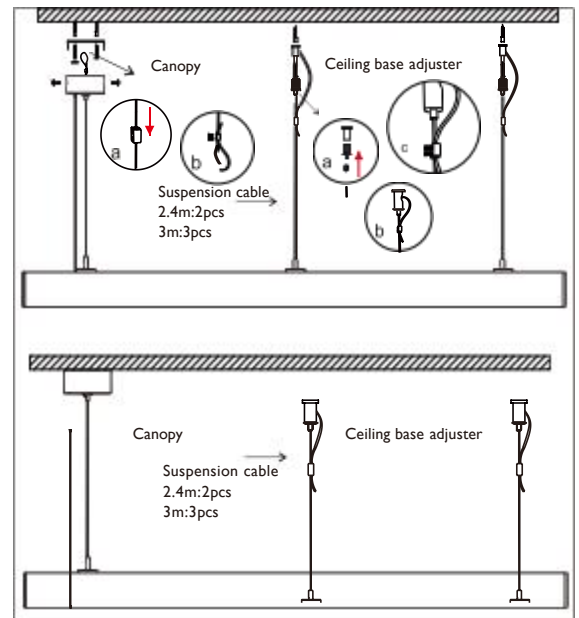

2. Insert the suspension cable into the ceiling base adjuster, connect AC cable, fix the ceiling canopy and Ceiling base adjuster to the ceiling.

Straight Joining Connector Installation (OPTIONAL)

"SOLD SEPARATELY ", Product No. : UGAMMA-V2-STRAIGHTJOINER

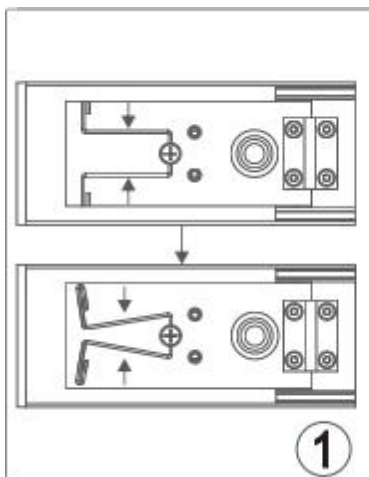

Loosen the limit wire on the flip and open the flip.

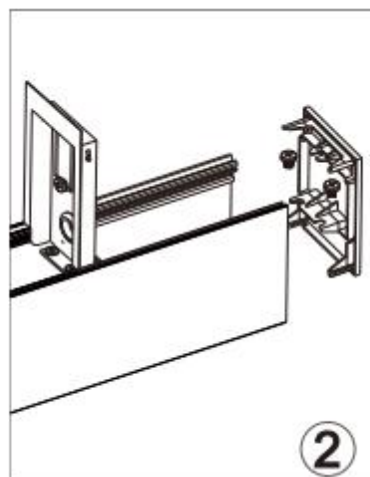

Loosen the screws on the end cap and remove the end cap.

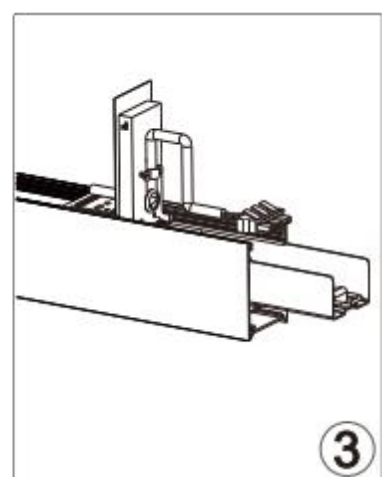

Link the AC cable, fix it on the flip, and insert the Straight connector to the profile.

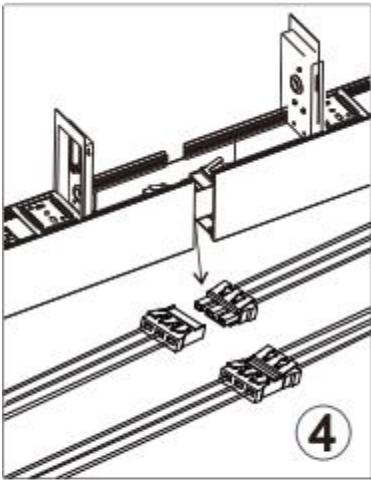

Connect the male/female connector from inside the lamp to the corresponding connector of another fixture.

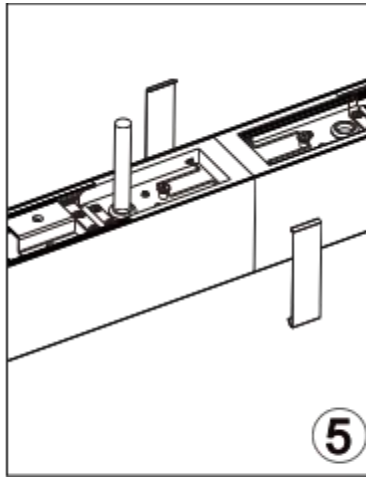

After connection, put the flip back and install the U shape covers (If included) at the joint between the two fixtures.

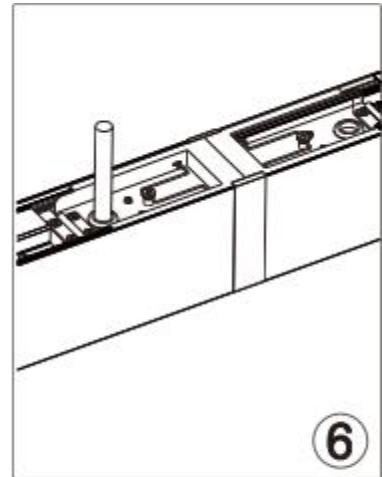

Fix up the U shape cover. Finished

Caution

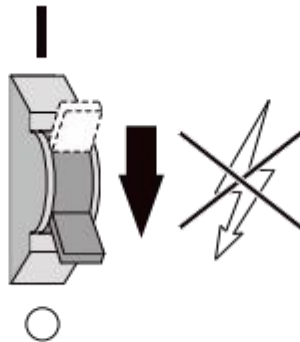
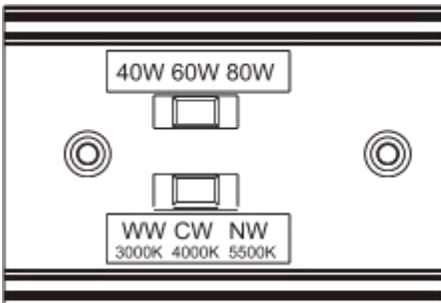

PLEASE DO NOT CHANGE WATTAGES OR ALTER COLOUR SELECTABLE WHEN THE LUMINAIRE IS TURN ON !!

IMPORTANT

The Gamma luminaire must be installed by qualified electrical contractor in accordance with current AS/NZS 3000