

Recessed Mount

T5 Linear Strip Lighting

NEW

IC-F



Made in Poland

EEL
Complies

T5

230V-240V



- Made from extruded and painted aluminium
- Electronic ballasted
- Acrylic diffuser
- Easy 'clip in'-'clip out' diffuser lens system
- Wall or Ceiling installation, horizontal or vertical
- Cavity depth 54-70mm

Watts	Hole Size	
	Height	Length
14W	50mm	592
21W		894
28W		1194
35W		1494

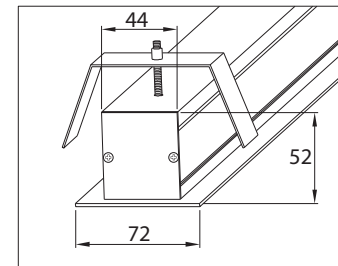

WHITE



LIND-14R-WH



LIND-21R-WH



LIND-28R-WH



LIND-35R-WH

14W

LIND-14R

- 616mm length overall flange

21W

LIND-21R

- 918mm length overall flange

28W

LIND-28R

- 1218mm length overall flange

35W

LIND-35R

- 1518mm length overall flange

GREY



LIND-14R-GY



LIND-21R-GY



LIND-28R-GY



LIND-35R-GY