

# 316 Stainless Steel Surface Mounted Eyelid Lights

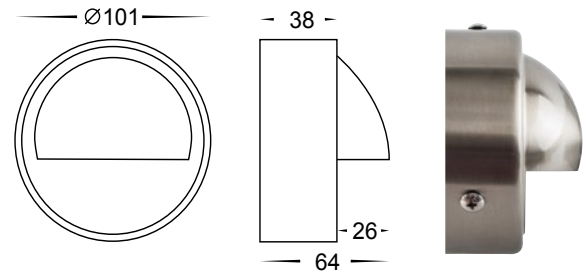

- Surface mounted eyelid (step light)
- Extra large eyelid design to maximise light output
- Full body stainless steel 316 marine grade
- Matt finish
- Frosted tempered glass
- IP rating: IP54



| IMAGE | PART NUMBER    | COLOUR TEMP       | OUTPUT | POWER           | INCLUDED GLOBES         |
|-------|----------------|-------------------|--------|-----------------|-------------------------|
|       | <b>HV2906</b>  | NA                | NA     | 240v G9 Max 25w | Not supplied with globe |
|       | <b>HV2907</b>  | NA                | NA     | 12v G4 MAx 20w  | Not supplied with globe |
|       | <b>HV2908C</b> | Cool white, 6000K | 180lm  | 240v LED 2.3w   | Built-in SMD 2.3w LED   |
|       | <b>HV2908W</b> | Warm white, 3000K | 160lm  | 240v LED 2.3w   | Built-in SMD 2.3w LED   |
|       | <b>HV2909C</b> | Cool white, 6000K | 180lm  | 12v DC LED 2.3w | Built-in SMD 2.3w LED   |
|       | <b>HV2909W</b> | Warm white, 3000K | 160lm  | 12v DC LED 2.3w | Built-in SMD 2.3w LED   |

*Optional Havit compatible G9 LED globe HV9511W*

*Optional Havit compatible G4 LED globe HV9529-3.2w*

All low voltage products that specify LED or are supplied with a 12v DC LED globe must be used with a suitable LED driver, refer to pages (185 - 206)  
Lumen output measured at source. All globes supplied with fittings are non dimmable. If you require 240v dimmable globes refer to pages (257 - 258)