

Flame 316 Stainless Steel

- DIY mini deck light
- Stainless Steel 316
- Frosted tempered glass
- RGB multi-function (HV2826RGB Only)
- 2x 1.5 metre cable length per light
- IP Rating: light fittings IP67 / driver IP66
- Suitable for in-ground installation
- Kit includes:
 - 6 x single deck light (0.5w per light)
 - 1x LED driver
 - 1x 4m extension cable
 - 1x RF RGB remote controller (HV2826RGB Only)

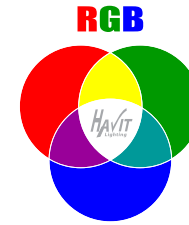
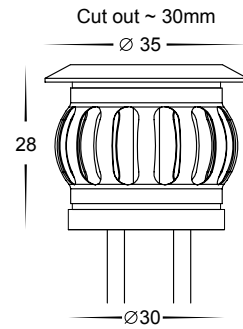
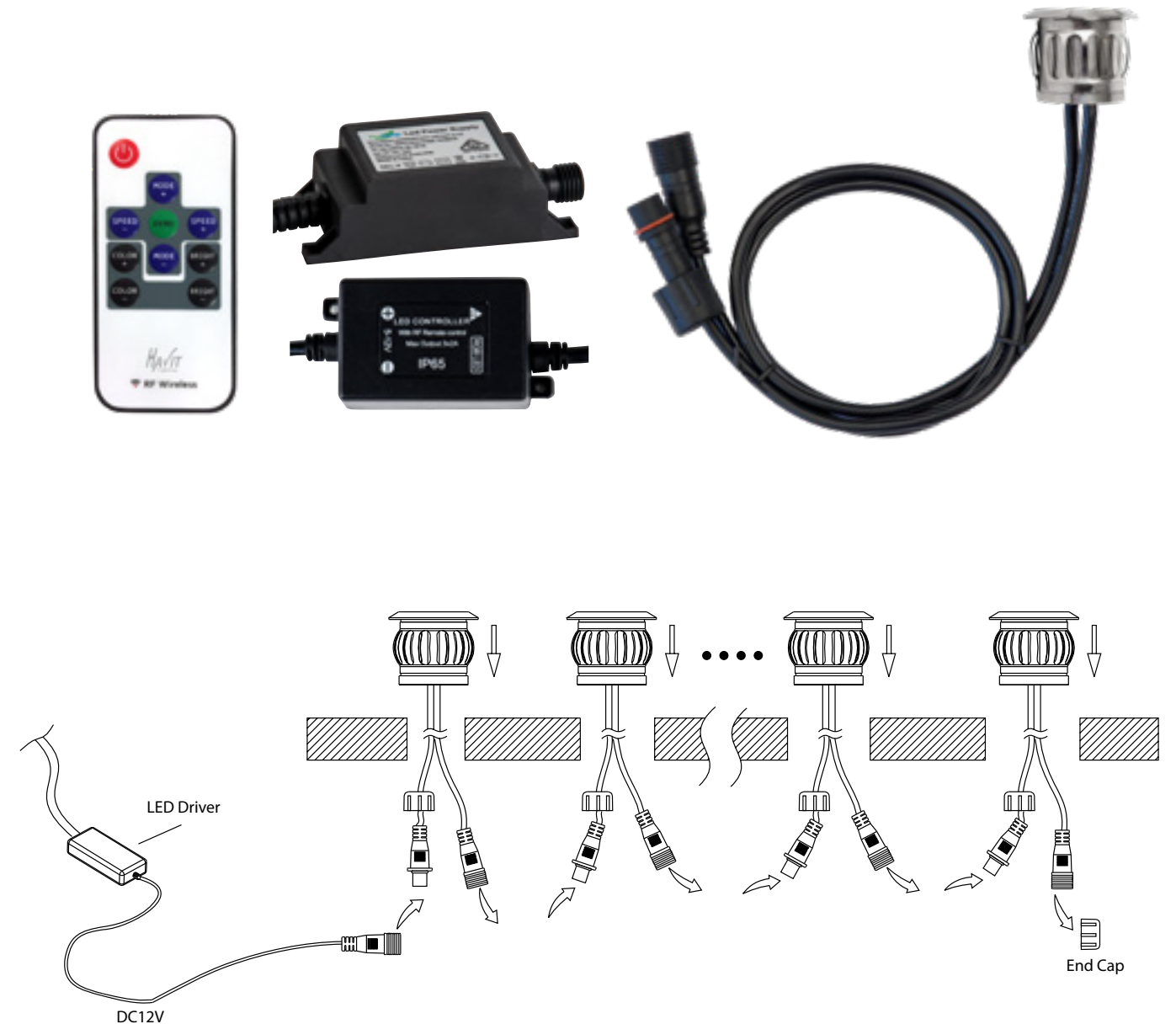

IMAGE	PART NUMBER	COLOUR TEMP	LUMENS	INPUT	INCLUDED LED
	HV2826C (6 light kit)	5500K	6x 50lm	Driver: 240v LED Fittings: 12v DC	Built-in 6 x 0.5w with Driver 6 x 0.5w with Driver and RF Controller
	HV2826W (6 light kit)	3000k	6x 40lm		
	HV2826RGB (6 light kit)	Multi Colour			
IMAGE	PART NUMBER	COLOUR TEMP	LUMENS	INPUT	INCLUDED LED
	HV28261C	5500K	50lm	12v DC	Built-in 0.5w
	HV28261W	3000k	40lm		
	HV28261RGB	Multi Colour			
	HV2826-D-12W	NA	NA	240v	NA
OPTIONAL ACCESSORIES					
	HV2826-2M-EXT	Optional 2 metre extension cable to extend length between fittings. Sold separately			
	HV2826RGB-2M-EXT				
	HV2826-4M-EXT	Optional 4 metre extension cable to extend length between fittings. Sold separately			
	HV2826RGB-4M-EXT				

Max 4 additional fittings (HV28261) can be added to the kit (HV2826). Total 10 fittings with supplied driver.
Larger kits can be configured using alternate Havit LED drivers.

All low voltage products that specify an input of 12v or 24v DC must be used with a suitable LED driver, refer to pages 267 - 274
Lumen output measured at source. All globes supplied with fittings are non dimmable. If you require 240v dimmable globes refer to page 336



All low voltage products that specify an input of 12v or 24v DC must be used with a suitable LED driver, refer to pages 267 - 274
Lumen output measured at source. All globes supplied with fittings are non dimmable. If you require 240v dimmable globes refer to page 336